



# COMPUTROL®

35 mm **film**  
bulk **loader**

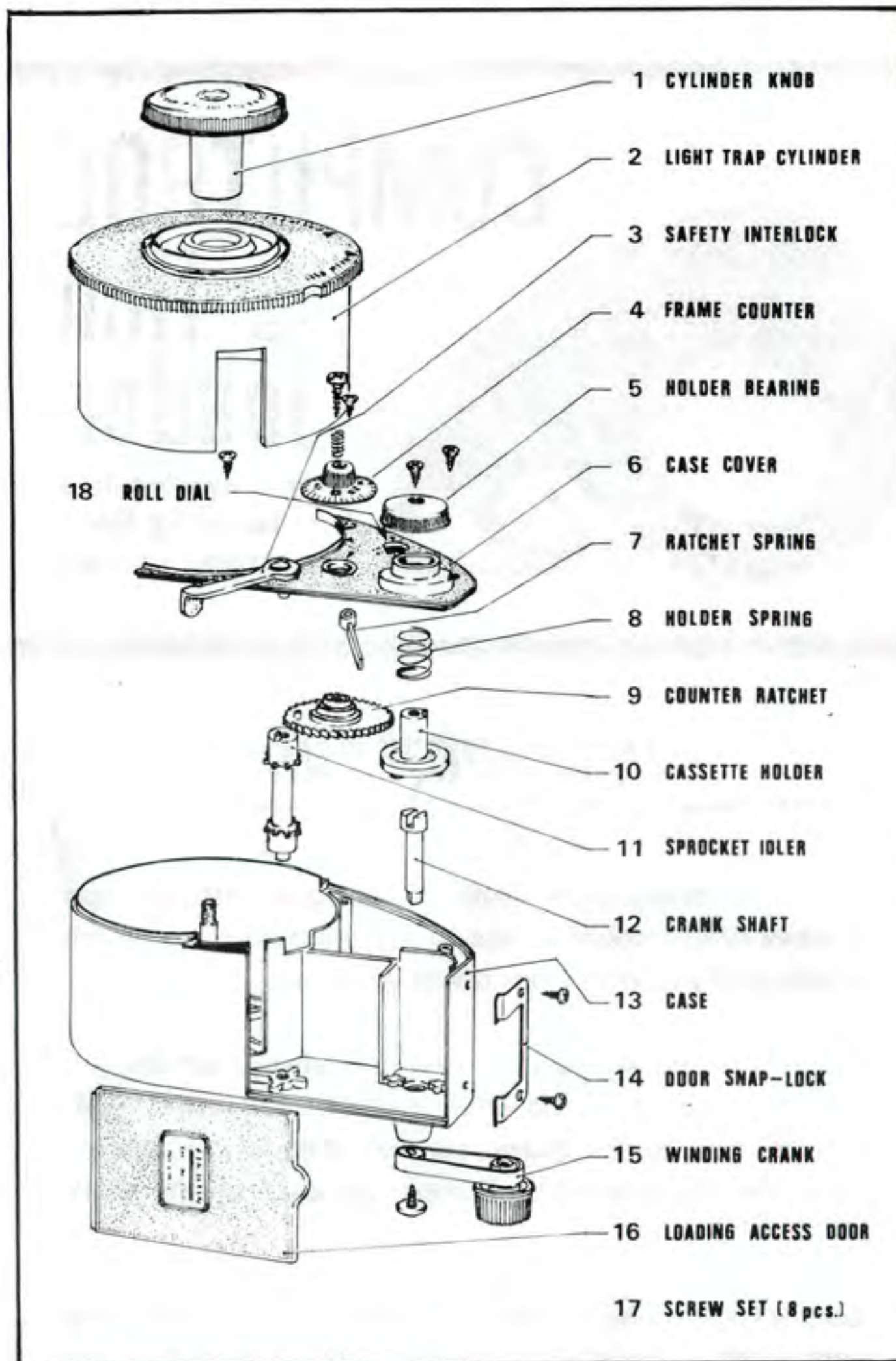
with synchronized  
remaining film  
and frame counters

## INSTRUCTIONS

This most advanced film loader is equipped with a unique positive-driven counter; accurately indicating the length of film still available from the original roll.

Before loading a new bulk film roll, always set the roll dial (18) (fig 1) to the original roll length (100ft, 50ft etc) by turning the frame counter knob (4) **clockwise**, until the corresponding number appears in the dial's window.

Zero setting of frame counter is obtained by turning the same knob . . **counter-clockwise** . . this turning does not affect the roll dial.



## ASSEMBLY INSTRUCTIONS FOR WINDING-CRANK.

Push crankshaft (12) through crank's hole at the bottom of case, making sure slotted end is **inside loader**, fit winding crank (15) over crankshaft end and tighten with screw supplied.



FIG.1

## HOW TO LOAD BULK FILM SUPPLY

1. Rotate the light-trap cylinder (2) clockwise to its stop (by grasping the knurled rim).
2. Rotate safety interlock lever (3) clockwise to its stop.
3. Snap out access door (16) and put it aside.
4. Unscrew cylinder knob (1) and put it aside.

**THE BULK FILM ROLL MUST BE LOADED IN TOTAL DARKNESS.**

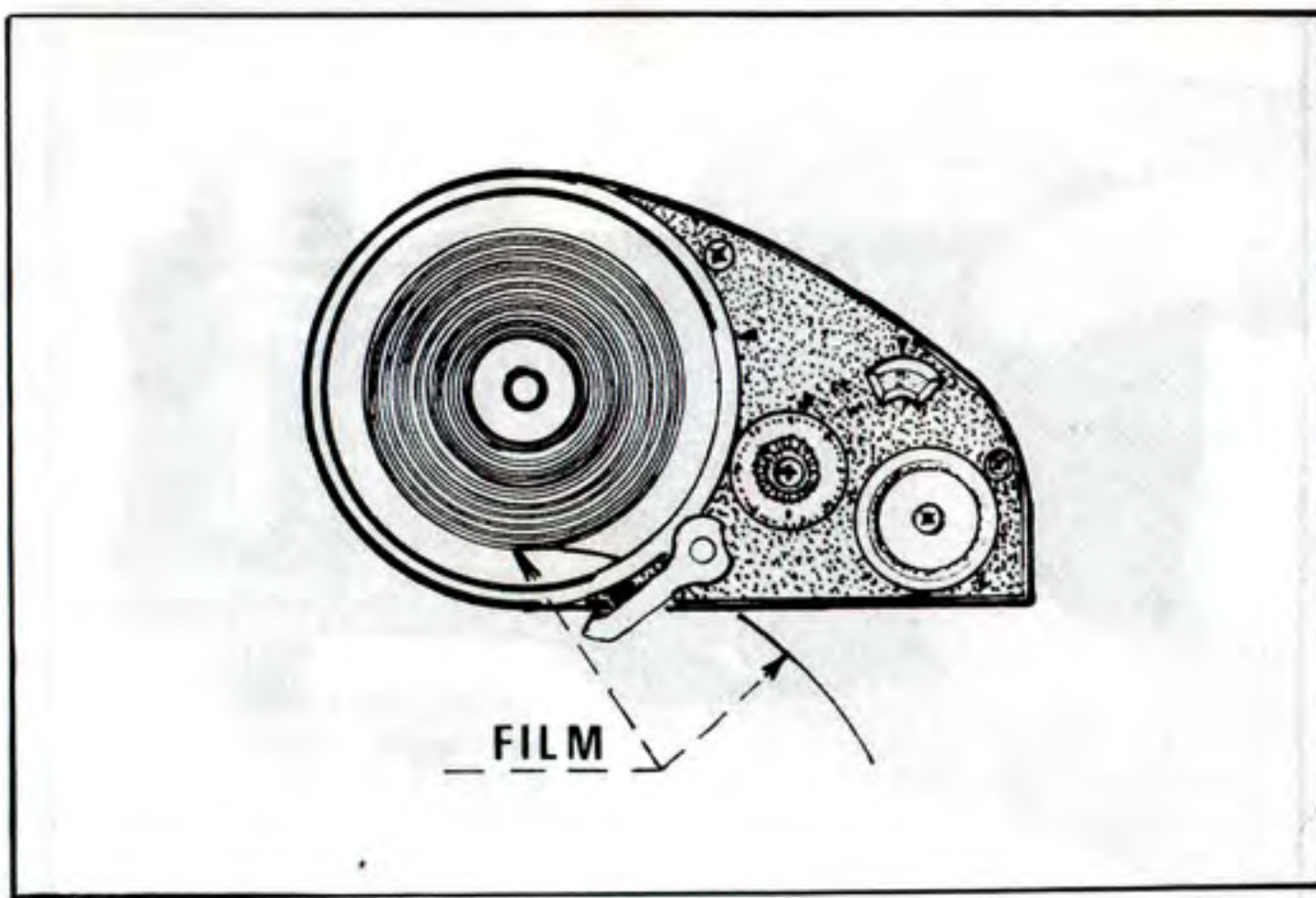
follow these instructions carefully:

1. Lift cylinder (2) from case (13).
2. Remove the fresh film roll from its packing and place its hub over the center spindle in the case, so it unrolls counter-clockwise when viewed from the top (fig. 2).
3. Pull about three inches of film through rectangular opening in the case and then replace the cylinder (2) in its original position (the interlock lever (3) will engage the notch in the cylinder rim - also arrow will indicate "TO INSERT CASSETTE").
4. Replace the cylinder knob (1) and hand tighten it.
5. Replace access door and secure it by turning the safety interlock (3) counter clockwise to its stop.
6. The **LOADER CAN** be used **NOW** for film loading in **DAYLIGHT**.

## WARNING!

In order to prevent unnecessary film spoilage, we strongly recommend to load one or two cassettes in order to practice the technique of easy and efficient loading. The loaded film should then be developed and checked for light leakage etc.

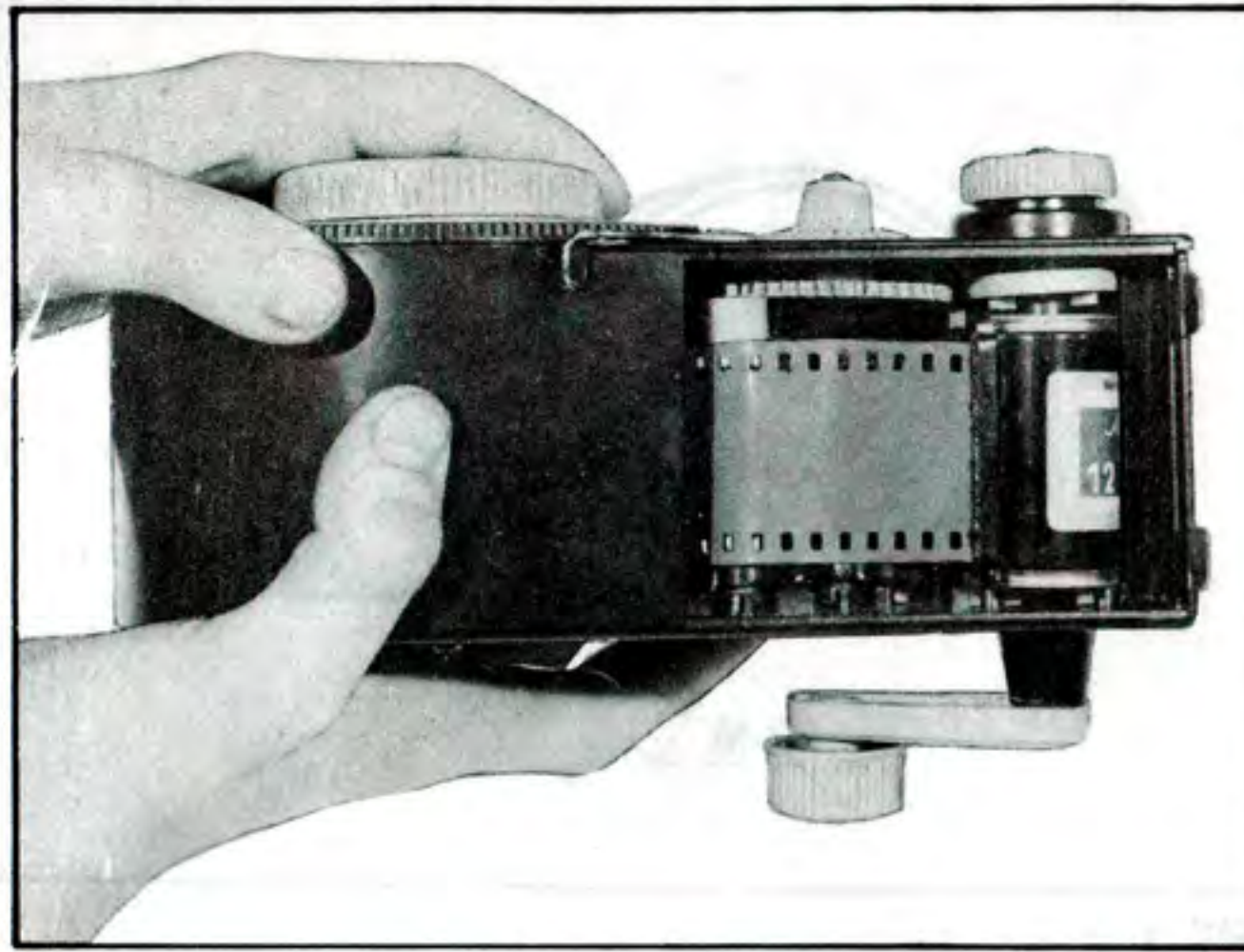




**FIG. 2**

## HOW TO LOAD CASSETTES AND CARTRIDGES IN DAYLIGHT.

1. Rotate safety interlock (3) clockwise to its stop and snap out access door.
2. Open a 35 mm reloadable cassette (available at your photo dealer) and remove the spool from cassette case.
3. Take a two inch length of  $\frac{3}{4}$ " masking tape, position the spool so, that the winding key end is at the bottom. Attach 1" of the tape to the center of the spool and attach the other tape end to the film. Make sure that the film is nested perfectly between the end rims of the spool.
4. Slide cassette case over the spool, threading film through cassette velvet light seal and lock cassette with its end cap.
5. Pull the spring-loaded holder bearing (5) and drop the cassette into the cassette chamber at the right end of the case. Release the holder bearing and let the cassette holder engage the cassette.
6. Position film so its perforations fit on sprocket idler (11), see (fig. 3).
7. Replace the access door; rotate the safety interlock lever (3) counter clockwise until it locks the access door; now rotate the cylinder (2) counter clockwise as far as it will go, (arrow will indicate "TO LOAD FILM").
8. Rotate the frame counter (4) counter clockwise to 37 or 38. Engage the winding crankshaft (12) by pushing it into the cassette's winding key and turn the crank (clockwise) until the film counter indicates 0. This setting counts out the unusable leader film.



**FIG. 3**

9. Now, holding the case while keeping the holder bearing (5) in place with one hand, wind on with the other hand as many exposures as you need (up to 40) and ADD additional three exposures, to provide you with leader. For example if you need 36 exposures, turn the crank until the frame counter indicates 39 etc.
10. Close the light trap cylinder by rotating it clockwise to its stop (arrow will indicate "TO INSERT CASSETTE"), rotate the safety interlock away from the access door to its stop, snap out access door, cut film apart and remove loaded cassette.
11. Replace access door and secure it with interlock lever.
12. With the leader positioned towards you, cut a  $1\frac{1}{2}$ " tapered section from the right hand end of the leader, see fig. 4.

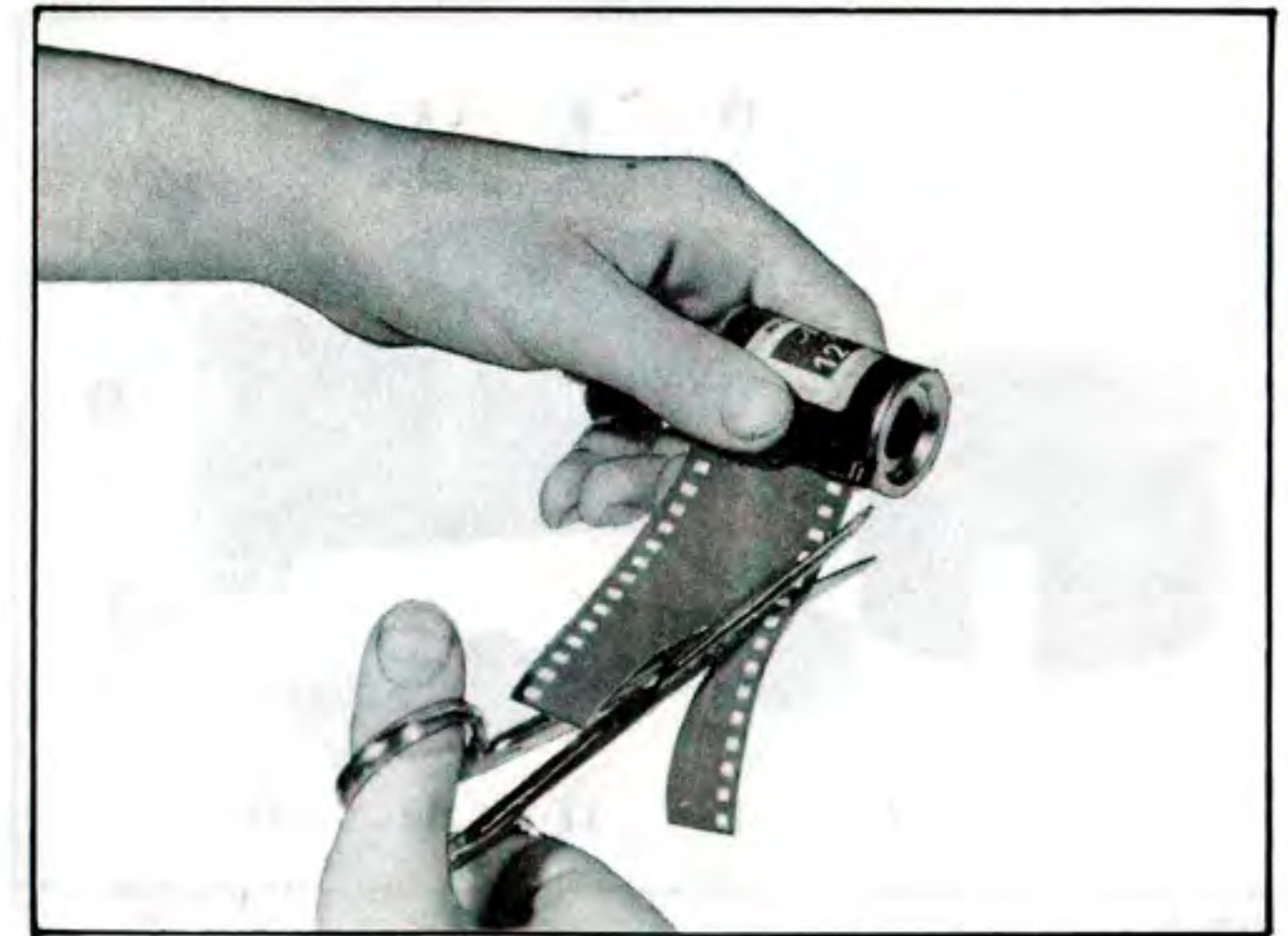
**IMPORTANT!! DO NOT EXPOSE THE LOADER NOR LOAD YOUR CASSETTES IN DIRECT SUNLIGHT.**

## USEFUL HINTS:

Your loader's case chamber should be cleaned out and be free from dust before loading it with Bulk film roll.

The velvet light seal on the cassette should be cleaned out periodically from dust, grit and other dirt.

If you use the loader infrequently, it is advisable to place the loader in a plastic bag and place it in a refrigerator. Film emulsions especially color last much longer in a cool, dry place, however allow loaded cassettes to stay at room temperature for a while in order to dry out condensed moisture before placing the cassette in the camera.



**FIG. 4**

## PARTS LIST

### Description

CYLINDER KNOB	CASSETTE HOLDER
LIGHT-TRAP CYLINDER	SPROCKET IDLER
SAFETY INTERLOCK	CRANK SHAFT
FRAME COUNTER	CASE
HOLDER BEARING	DOOR SNAP-LOCK
CASE COVER	WINDING CRANK
RATCHET SPRING	LOADING ACCESS DOOR
HOLDER SPRING	SCREW SET
COUNTER RATCHET	ROLL DIAL

INSTRUCTION MANUAL